



FROG CYGNUS

GENERAL

Type: Workboat
 Built: 1990, New m/e's 2020
 Class: Ice class I
 Flag: Sweden
 Dimensions O.A: LOA: 20,30 m BOA: 6,05 m
 Mean Draft: 2,4 m
 GRT: 93
 MMSI number: 265644320
 Call sign: SFQN
 Port of registry: GÖTEBORG

PERFORMANCE

Speed free running: 9 kts
 Bollard pull: 6 MT

TANK CAPACITIES

Fuel oil: 7 cbm
 Dirty oil: 0,3 cbm
 Fresh Water: 2 cbm
 Sewage: 2 cbm

AUXILIARY EQUIPMENT

Main generator set: Volvo Penta D5

Hydraulic set: 140bar 50L/min

PROPULSION

Propellers: 2 x Aquamaster
 Total power: 2 x 261 kW
 Main engines: 2 x Volvo D8 355Hp

DECK

Deck Crane: 2 Ton, 1 Ton at 7,3m
 A-Frame: 2 Ton
 AH/Towing winch: 5 T
 Clear deck space: 25 m2
 Dive equipment: Fixed Helmet AH3
 Hull cleaning: Hull wiper

NAVIGATION EQUIPMENT

Magnetic compass: Cassens & Plath
 Satellite compass: Furuno
 RADAR: Furuno
 Autopilot: Simrad
 AIS: Furuno
 Echosounder: Simrad
 VHF/DSC: Trane&Thrane Sailor
 Handheld VHF: Sailor
 Navigation: Olex

ACCOMMODATION

2 cabins with 2 bunks each.
 1 toilet with shower and 1 deck toilet
 Pantry with smaller messroom.

Details believed to be correct but not guaranteed and can be subject to change.

For contact details please visit our website www.sse-ab.se

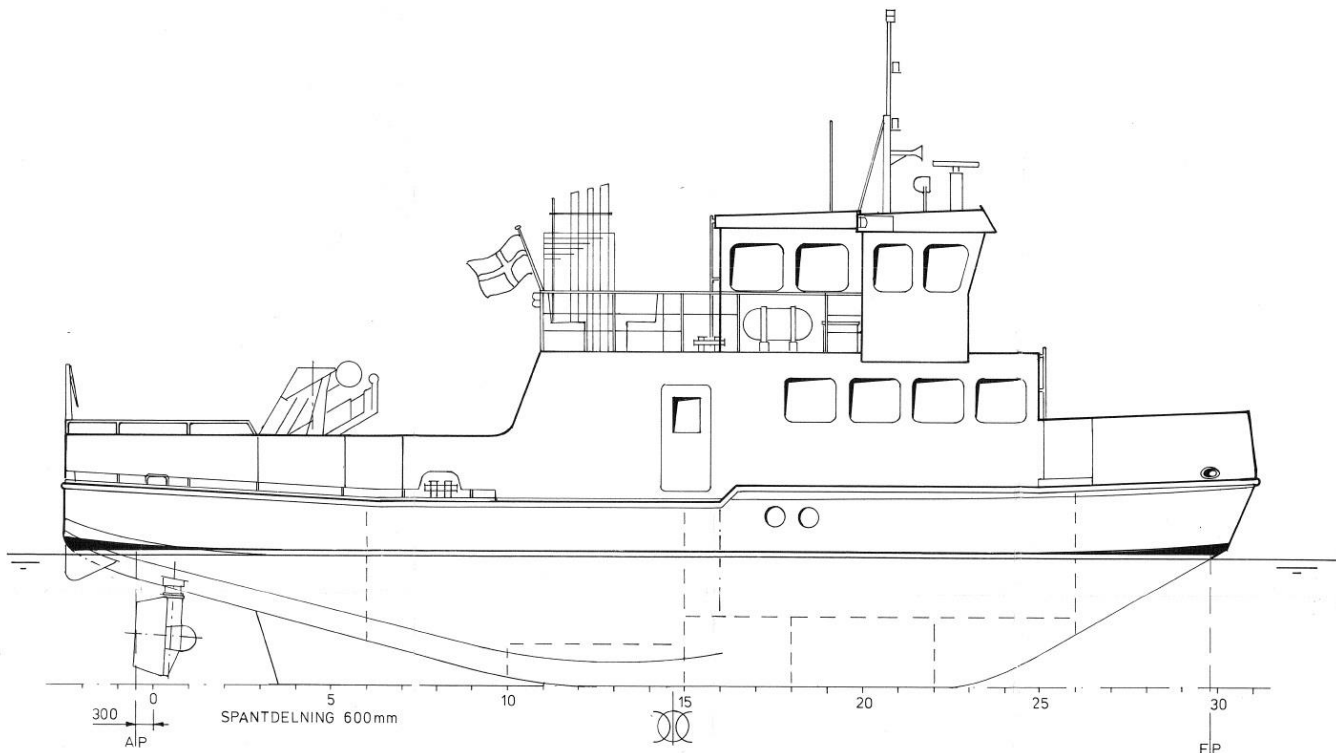

SIDE VIEW

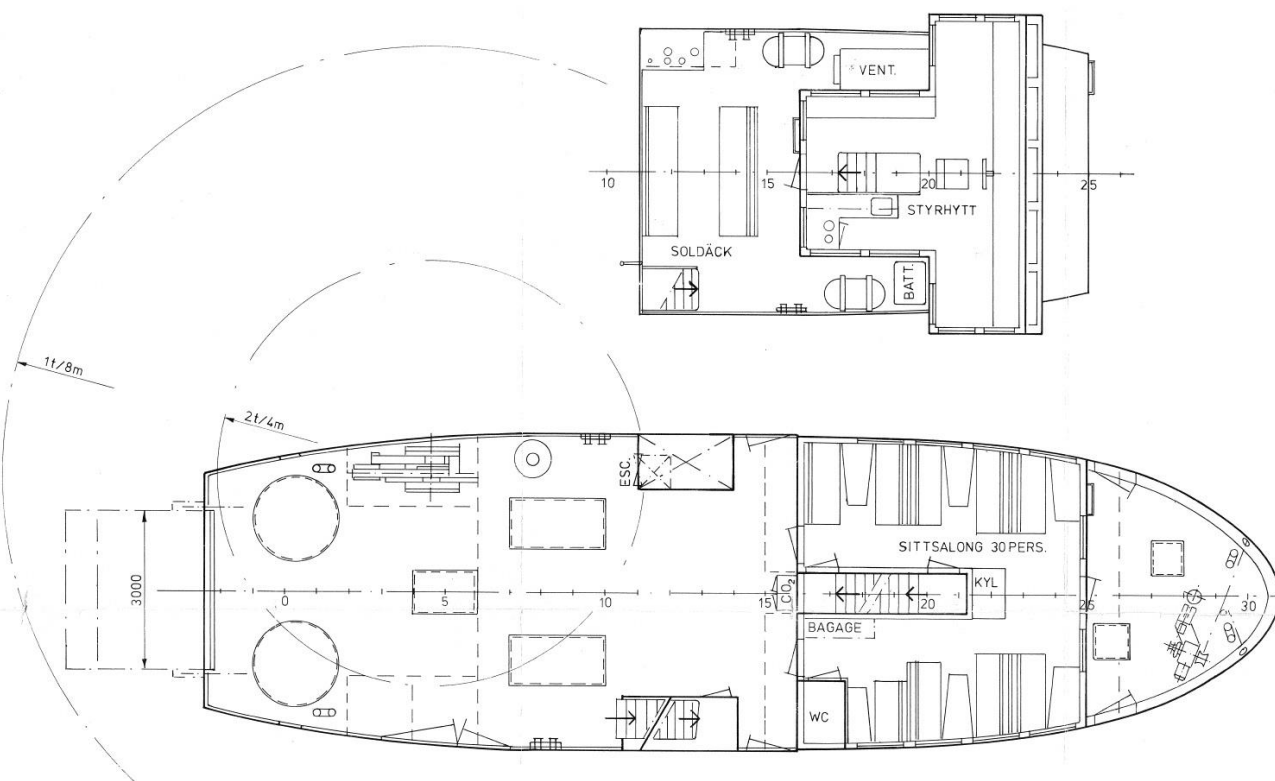

MAIN DECK

Details believed to be correct but not guaranteed and can be subject to change.

FROG CYGNUS

For contact details please visit our website www.sse-ab.se

