



SOUND EXPRESS

GENERAL

Type: Damen Fast Crew Supplier 2610
 Built: 2016
 Class: I ✕ Hull, • MACH Light Ship/Fast Utility Vessel, Sea Area 3, • AUT – UMS
 Flag: United Kingdom
 Dimensions O.A (draft): 25,12mtr x 10,14mtr x 3,0mtr
 GRT: 161
 MMSI: 232006139
 IMO number: 9813553
 Call sign: MAOB7
 Port of registry: Southampton, United Kingdom

PERFORMANCE

Speed free running: 25 knots

TANK CAPACITIES

Fuel oil: 22,2 m³
 Dirty oil: 0,33 m³
 Fresh Water: 1,8 m³
 Sewage: 0,50 m³

AUXILIARY EQUIPMENT

Main generator sets: 2 x Caterpillar C2.2 T
 Capacity: 2 x 28 kVA, 50Hz, 230/400V

PROPULSION

Propellers: 2 x Van Voorden, Class 1 NiAl-Bronze
 Main engines: 2 x Caterpillar C32
 Total power: 1492 kW (2029 hp)
 Bow thruster: Hydrosta Sider 60 hp, hydraulic

DECK

Deck crane: Heila HLM 020-25
 Deck carrying capacity: 10 ton
 Clear deck space: 90 m²

ACCOMMODATION

There is an accommodation with 12 Norsap 800 chairs to transport persons, and with an adjacent galley.
 1 Double bedroom, 2 Single bed rooms.
 Messroom and galley

NAVIGATION EQUIPMENT

Searchlights: 1x SEEMATZ 463 HGS 1000W
 Magnetic compass: ALPHATRON JRC JLR 21
 Satellite compass: JRC GPSCOMPASS 3D DYNAMIC SENSOR
 RADAR: 1x X-BAND JRC JMA-5212-4 + 1x 17" display
 JRC
 GPS: ALPHATRON ALPHASEAPILOT MFC
 Autopilot: JRC JHS 182
 AIS: JRC JFE-380 200/50 kHz
 Echosounder: 2x SAILOR RT6222
 VHF/DSC: 2x SAILOR SP3510
 Handheld VHF: MF/HF SAILOR 6301
 SSB/DSC: JRC NCR-333
 Navtex: ECDIS Transas NS4000
 Navigation: + ALPHATRON 19" Alphascreen
 Alphacall MF
 Intercom: Seamarshall Sarfinder 1003
 Crew finder:

Details believed to be correct but not guaranteed and can be subject to change.



**For contact details please visit
 our website www.sse-ab.se**

PROFILE

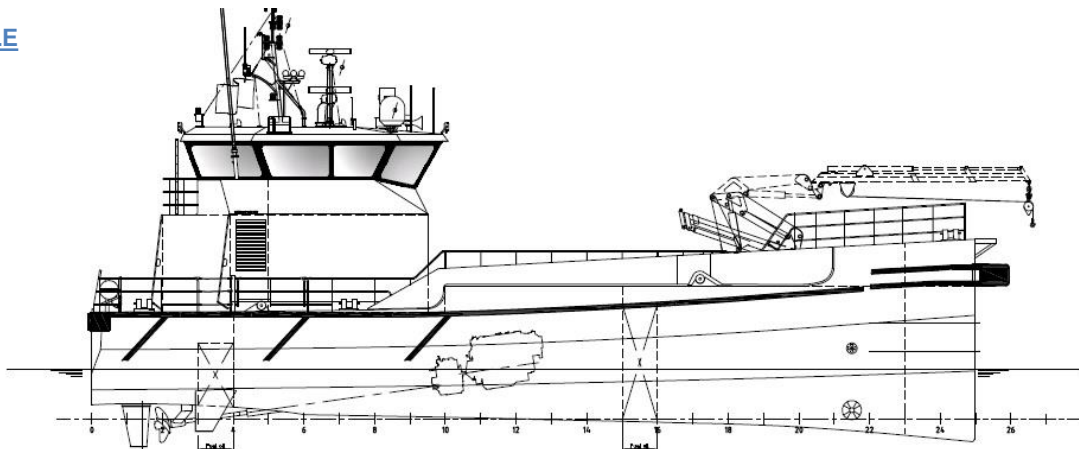

BRIDGE DECK

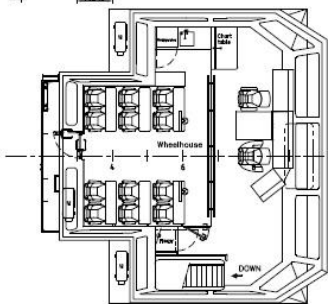

MAINDECK

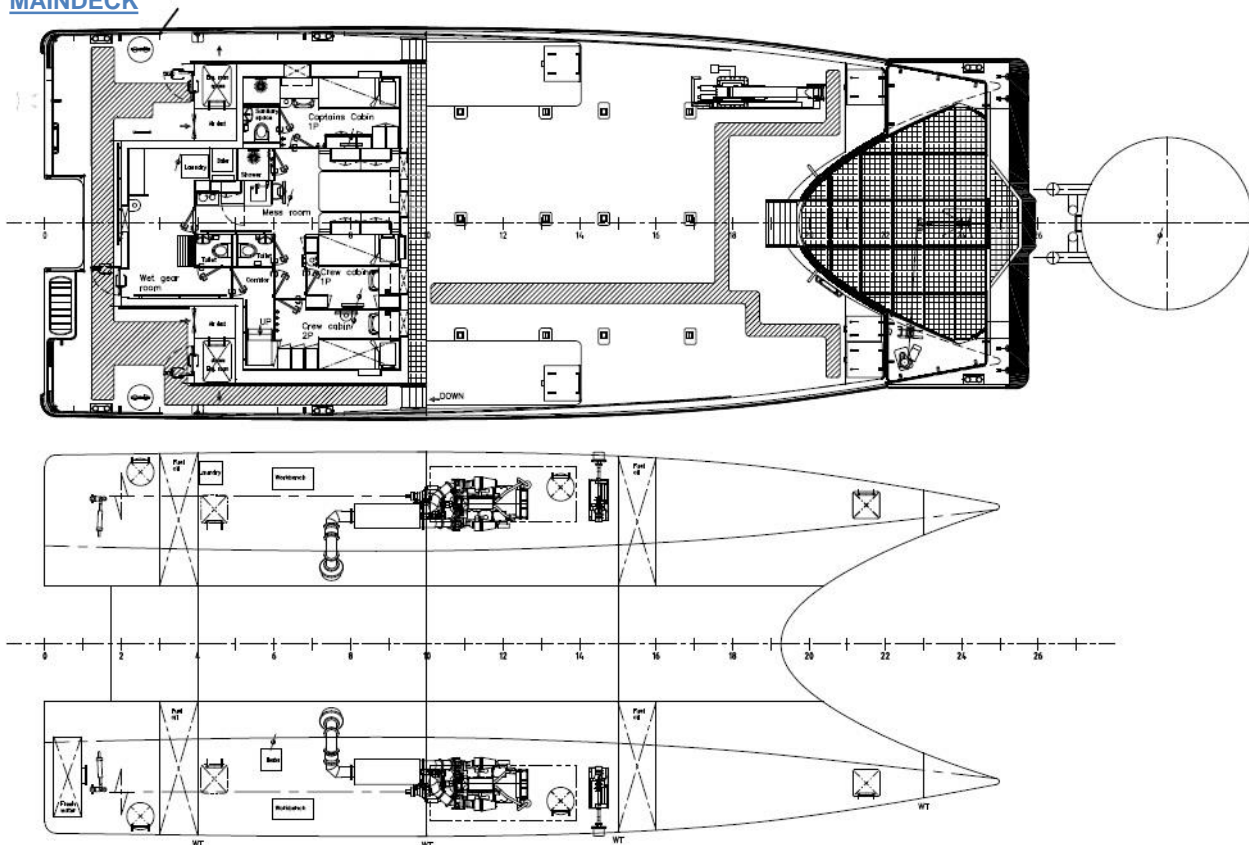

BELOW MAINDECK



SOUND EXPRESS

For contact details please visit
our website www.sse-ab.se